



# A68 PN10-40

## flanged type ball valve

INVESTMENT CASTING BODY  
CORPO DA FUSIONE

PART NAME PARTICOLARE	Q.TY Q.TA'	MATERIALS MATERIALI	
1 body corpo	1	ASTM A216 WCB	ASTM A351 CF8M
2 stud tirante	4/8	ASTM A193 B7	ASTM A193 B8M
2b nut dado	4/8	ASTM A194 2H	ASTM A194 B8
3 closure chiusura	1	ASTM A216 WCB	ASTM A351 CF8M
4 stem stelo	1	ASTM A182 316/316L	
5 ball sfera	1	ASTM A351 CF8M	
6 seats sedi	2	TFM	
7 1 <sup>st</sup> body gasket guarnizione corpo int.	1	P.T.F.E. (DN < 80)	
7a 2 <sup>nd</sup> body gasket guarnizione corpo est.	1	GRAPHOIL	
8 washer bussola	1	P.T.F.E.	
8a stem gasket guarnizione stelo	1	GRAPHOIL	
9 gland preguarnizione	1	Carbon Steel Zinc Coated	Stainless Steel 316
10 lever leva	1	Carbon Steel Zinc Coated	Carbon Steel Zinc Coated
11 stem nut dado stelo	2	Cl. 8	A4-40 (AISI 316)
12 spring washer molla a tazza	2	51CrV4 Zinc Coated	AISI 316
13 stop device dispositivo di arresto	1	Cl. 8.8 Zinc Coated	AISI 316
14 antistatic device dispositivo antistatico	2	AISI 316	
15 stem O-ring O-ring stelo	1	VITON 75 Sh. A	
16 body O-ring O-ring corpo	1	P.T.F.E. (DN > 100)	

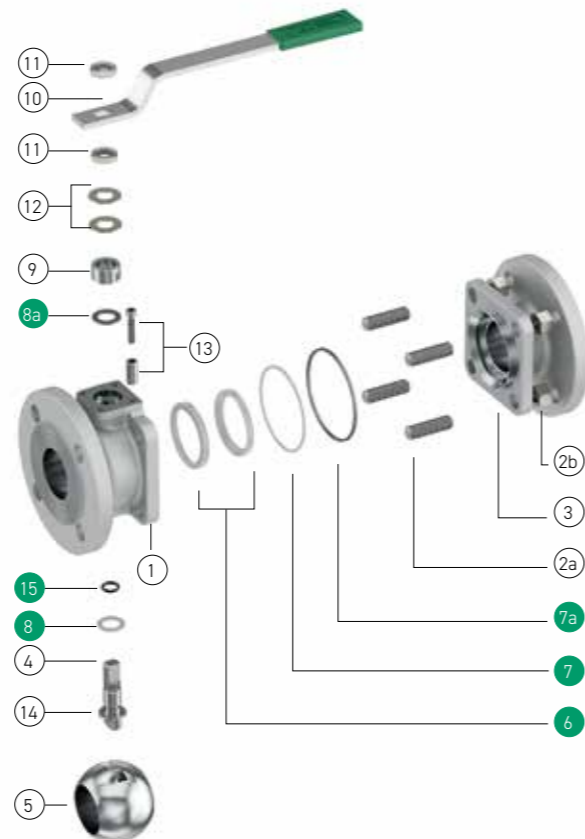

Spares parts / Parti di ricambio

### STANDARD FEATURES CARATTERISTICHE STANDARD

Flange Facing RF according to / Finitura Flange RF secondo : EN 1092-1
Flange drilling, smooth holes according / Foratura flange, fori lisci secondo : EN 1092-1, PN16
Face to face / Scartamento : DIN 3202 F4 (DN < 100), DIN 3202 F5 (DN > 125)
Design according to / Progettazione secondo : ASME B16.34, EN 12516-1, PED 2014/68/UE
Fire Safe Design and Construction according to / Costruzione e assemblaggio Fire Safe secondo : EN ISO 10497, API 6FA, API 607
Antistatic Device according to / Antistatic Device according to : BS 5146
Tightness class / Classe di tenuta : VI (FCI 70-2 - ANSI B 16.104)
Stem sealing with O-ring, Anti Blow-out stem / Tenuta stelo con O-Ring, stelo anti-espulsione
Actuator coupling flange according to / Flangia integrata per montaggio comando secondo : ISO 5211

### A68 PN10-40 CARBON STEEL BODY / CORPO ACCIAIO AL CARBONIO

DN	VALVE RATING	VALVE CODE	DESCRIPTION	VALVE PRICE (€)	KIT CODE	KIT PRICE (€)
20	PN 10-40	A6820U4C1-0001-M0010	ALFA68 DN20 PN 10-40 WCB FS RF		KGA6420A1-001	
25	PN 10-40	A6825U4C1-0001-M0010	ALFA68 DN25 PN 10-40 WCB FS RF		KGA6425A1-001	
32	PN 10-40	A6832U4C1-0001-M0010	ALFA68 DN32 PN 10-40 WCB FS RF		KGA6432A1-001	
40	PN 10-40	A6840U4C1-0001-M0010	ALFA68 DN40 PN 10-40 WCB FS RF		KGA6440A1-001	
50	<b>PN 10-40</b>	<b>A6050U4C1-0001-M0010</b>	<b>ALFA68 DN50 PN 10-40 WCB FS RF</b>		<b>KGA6450A1-001</b>	
65	PN 10-16	A6065U3C1-0001-M0010	ALFA68 DN65 PN 10-16 WCB FS RF		KGA6465A1-001	
80	PN 10-16	A6080U3C1-0001-M0010	ALFA68 DN80 PN 10-16 WCB FS RF		KGA6480A1-001	
100	PN 10-16	A60A0U3C1-0001-M0010	ALFA68 DN100 PN 10-16 WCB FS RF		KGA64A0A1-002	
150	PN 10-16	A60A5U3C1-0001-M0010	ALFA68 DN150 PN 10-16 WCB FS RF		KGA64A5A1-001	
200	PN16	A60B0U3C1-0001-K0010	ALFA68 DN200 PN 16 WCB FS RF		KGA64B0A1-001	

(\*) BARE STEM VALVE- VALVOLA A STELO NUDO

### A68 PN 10-40 STAINLESS STEEL BODY / CORPO ACCIAIO INOSSIDABILE

DN	VALVE RATING	VALVE CODE	DESCRIPTION	VALVE PRICE (€)	KIT CODE	KIT PRICE (€)
15	PN 10-40	A6815U4S2-0001-M0000	ALFA68 DN15 PN 10-40 CF8M FS RF		KGA6415A1-001	
20	PN 10-40	A6820U4S2-0001-M0000	ALFA68 DN20 PN 10-40 CF8M FS RF		KGA6420A1-001	
25	PN 10-40	A6825U4S2-0001-M0000	ALFA68 DN25 PN 10-40 CF8M FS RF		KGA6425A1-001	
32	PN 10-40	A6832U4S2-0001-M0000	ALFA68 DN32 PN 10-40 CF8M FS RF		KGA6432A1-001	
40	PN 10-40	A6840U4S2-0001-M0000	ALFA68 DN40 PN 10-40 CF8M FS RF		KGA6440A1-001	
50	PN 10-40	A6050U4S2-0001-M0000	ALFA68 DN50 PN 10-40 CF8M FS RF		KGA6450A1-001	
65	PN 10-16	A6065U3S2-0001-M0000	ALFA68 DN65 PN 10-16 CF8M FS RF		KGA6465A1-001	
80	PN 10-16	A6080U3S2-0001-M0000	ALFA68 DN80 PN 10-16 CF8M FS RF		KGA6480A1-001	
100	PN 10-16	A60A0U3S2-0001-M0000	ALFA68 DN100 PN 10-16 CF8M FS RF		KGA64A0A1-002	

(\*) BARE STEM VALVE- VALVOLA A STELO NUDO



Product codes in bold are related to product available on stock; delivery time within 3 weeks based on ordered quantity.  
All other codes are related to product ready for assembly; delivery time within 5 weeks based on ordered quantity.  
Missing Sizes and Special Executions are available upon request. Please contact Sales Dept. for availability and delivery time.  
**I codici in grassetto indicano prodotti normalmente disponibili a stock; consegna entro 3 settimane secondo quantità ordinate.**  
Gli altri codici indicano prodotti disponibili per assemblaggio; consegna entro 5 settimane secondo quantità ordinate.  
Dimensioni mancanti ed esecuzioni speciali sono disponibili su richiesta. Si prega contattare Ufficio commerciale per disponibilità e consegne.