

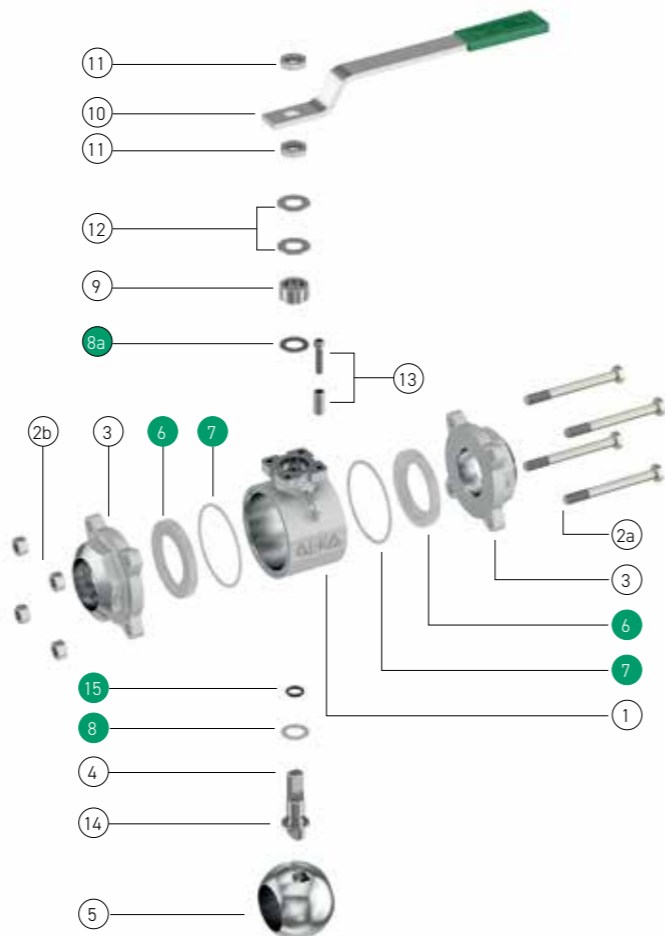

## A24K PN40-63 3 pieces type ball valve

PART NAME PARTICOLARE	Q.TY Q.TA'	MATERIALS MATERIALI	
1 body corpo	1	ASTM A216 WCB	ASTM A351 CF8M
2a screw vite	4/6	ASTM A453 Gr.660A	A4-70
2b nut dado	4/6	ASTM A453 Gr.660A	A4-70
3 closure chiusura	2	ASTM A216 WCB	ASTM A351 CF8M
4 stem stelo	1	ASTM A479 F6a (AISI 410)	ASTM A182 316/316L
5 ball sfera	1	ASTM A351 CF8	ASTM A351 CF8M
6 seats sedi	2	TFM	
7 body gasket guarnizione corpo	2	GRAPHOIL	P.T.F.E.
8 washer bussola	1	P.T.F.E.	
8a stem gasket guarnizione stelo	1	GRAPHOIL	P.T.F.E.
9 gland preguarnizione	1	Carbon Steel Zinc Coated	Stainless Steel 316
10 lever leva	1	Carbon Steel Zinc Coated	
11 stem nut dado stelo	2	Cl. 8	A4-40 (AISI 316)
12 spring washer molla a tazza	2	51CrV4 Zinc Coated	AISI 316
13 stop device dispositivo di arresto	1	Cl.8.8 Zinc Coated	AISI 316
14 antistatic device dispositivo antistatico	2	AISI 316	
15 stem O-ring O-ring stelo	1	VITON 75 Sh. A	



Spares parts / Parti di ricambio

### STANDARD FEATURES CARATTERISTICHE STANDARD

Flange Facing / Finitura Flange : NPT (ASME B1.20.1)-GAS (ISO 228/1)-BW Sch.40(ASME B16.25)  
SW (ASME B16.11)

Face to face / Scartamento : DIN 3203-M3

Design according to / Progettazione secondo : ASME B16.34, EN 12516-1, PED 2014/68/UE

Fire Safe Design and Construction according to / Costruzione e assemblaggio Fire Safe secondo :  
EN ISO 10497, API 6FA, API 607 ( Standard only for WCB)

Antistatic Device according to / Dispositivo antistatico secondo : BS 5146

Tightness class / Classe di tenuta : VI (FCI 70-2 - ANSI B 16.104)

Stem sealing with O-ring, Anti Blow-out stem / Tenuta stelo con O-Ring, stelo anti-espulsione

Actuator coupling flange according to / Flangia integrata per montaggio comando secondo : ISO 5211

### A24K PN 40-63 CARBON STEEL BODY / CORPO ACCIAIO AL CARBONIO STANDARD EXECUTION: FIRE SAFE

WCB

DN	VALVE RATING	VALVE CODE	DESCRIPTION	VALVE PRICE (€)	KIT CODE	KIT PRICE (€)
06	PN63	A2406UAC1-0003-M0000	ALFA24K DN06 PN63 WCB GAS FS		N.A. (*)	
06	PN63	A2406UAC1-0004-M0000	ALFA24K DN06 PN63 WCB NPT FS		N.A. (*)	
06	PN63	A2406UAC1-0005-M0000	ALFA24K DN06 PN63 WCB BW FS		N.A. (*)	
06	PN63	A2406UAC1-0002-M0000	ALFA24K DN06 PN63 WCB SW FS		N.A. (*)	
10	PN63	A2410UAC1-0002-M0000	ALFA24K DN10 PN63 WCB GAS FS		N.A. (*)	
10	PN63	A2410UAC1-0001-M0000	ALFA24K DN10 PN63 WCB NPT FS		N.A. (*)	
10	PN63	A2410UAC1-0004-M0000	ALFA24K DN10 PN63 WCB BW FS		N.A. (*)	
10	PN63	A2410UAC1-0003-M0000	ALFA24K DN10 PN63 WCB SW FS		N.A. (*)	
<b>15</b>	<b>PN63</b>	<b>A2415UAC1-0002-M0000</b>	<b>ALFA24K DN15 PN63 WCB GAS FS</b>		<b>KGA2415UA-002</b>	
<b>15</b>	<b>PN63</b>	<b>A2415UAC1-0001-M0000</b>	<b>ALFA24K DN15 PN63 WCB NPT FS</b>		<b>KGA2415UA-002</b>	
15	PN63	A2415UAC1-0004-M0000	ALFA24K DN15 PN63 WCB BW FS		KGA2415UA-002	
15	PN63	A2415UAC1-0003-M0000	ALFA24K DN15 PN63 WCB SW FS		KGA2415UA-002	
<b>20</b>	<b>PN63</b>	<b>A2420UAC1-0002-M0000</b>	<b>ALFA24K DN20 PN63 WCB GAS FS</b>		<b>KGA2420UA-002</b>	
<b>20</b>	<b>PN63</b>	<b>A2420UAC1-0001-M0000</b>	<b>ALFA24K DN20 PN63 WCB NPT FS</b>		<b>KGA2420UA-002</b>	
20	PN63	A2420UAC1-0004-M0000	ALFA24K DN20 PN63 WCB BW FS		KGA2420UA-002	
20	PN63	A2420UAC1-0003-M0000	ALFA24K DN20 PN63 WCB SW FS		KGA2420UA-002	
<b>25</b>	<b>PN63</b>	<b>A2425UAC1-0002-M0000</b>	<b>ALFA24K DN25 PN63 WCB GAS FS</b>		<b>KGA2425UA-002</b>	
<b>25</b>	<b>PN63</b>	<b>A2425UAC1-0001-M0000</b>	<b>ALFA24K DN25 PN63 WCB NPT FS</b>		<b>KGA2425UA-002</b>	
25	PN63	A2425UAC1-0004-M0000	ALFA24K DN25 PN63 WCB BW FS		KGA2425UA-002	
25	PN63	A2425UAC1-0003-M0000	ALFA24K DN25 PN63 WCB SW FS		KGA2425UA-002	
32	PN63	A2432UAC1-0002-M0000	ALFA24K DN32 PN63 WCB GAS FS		KGA2432UA-002	
32	PN63	A2432UAC1-0001-M0000	ALFA24K DN32 PN63 WCB NPT FS		KGA2432UA-002	
32	PN63	A2432UAC1-0004-M0000	ALFA24K DN32 PN63 WCB BW FS		KGA2432UA-002	
32	PN63	A2432UAC1-0003-M0000	ALFA24K DN32 PN63 WCB SW FS		KGA2432UA-002	
<b>40</b>	<b>PN63</b>	<b>A2440UAC1-0002-M0000</b>	<b>ALFA24K DN40 PN63 WCB GAS FS</b>		<b>KGA2440UA-002</b>	
<b>40</b>	<b>PN63</b>	<b>A2440UAC1-0001-M0000</b>	<b>ALFA24K DN40 PN63 WCB NPT FS</b>		<b>KGA2440UA-002</b>	
40	PN63	A2440UAC1-0004-M0000	ALFA24K DN40 PN63 WCB BW FS		KGA2440UA-002	
40	PN63	A2440UAC1-0003-M0000	ALFA24K DN40 PN63 WCB SW FS		KGA2440UA-002	
<b>50</b>	<b>PN40</b>	<b>A2450U9C1-0002-M0000</b>	<b>ALFA24K DN50 PN40 WCB GAS FS</b>		<b>KGA2450U9-003</b>	
<b>50</b>	<b>PN40</b>	<b>A2450U9C1-0001-M0000</b>	<b>ALFA24K DN50 PN40 WCB NPT FS</b>		<b>KGA2450U9-003</b>	
50	PN40	A2450U9C1-0004-M0000	ALFA24K DN50 PN40 WCB BW FS		KGA2450U9-003	
50	PN40	A2450U9C1-0003-M0000	ALFA24K DN50 PN40 WCB SW FS		KGA2450U9-003	
80	PN40	A2480U9C1-0001-M0000	ALFA24K DN80 PN40 WCB NPT FS		KGA2480U9-002	

(\*) FOR VALVES DN06/DN10 SPARE PARTS KIT WILL NOT BE AVAILABLE - I KIT DI RICAMBIO NON SONO DISPONIBILI PER VALVOLE DN06/10



Product codes in bold are related to product available on stock; delivery time within 3 weeks based on ordered quantity.

All other codes are related to product ready for assembly; delivery time within 5 weeks based on ordered quantity.

Missing Sizes and Special Executions are available upon request. Please contact Sales Dept. for availability and delivery time

I codici in grassetto indicano prodotti normalmente disponibili a stock; consegna entro 3 settimane secondo quantità ordinate

Gli altri codici indicano prodotti disponibili per assemblaggio; consegna entro 5 settimane secondo quantità ordinate

Dimensioni mancanti ed esecuzioni speciali sono disponibili su richiesta. Si prega contattare Ufficio commerciale per disponibilità e consegne

## A24K PN 40-63

STAINLESS STEEL BODY / CORPO ACCIAIO INOSSIDABILE

STANDARD EXECUTION: NO FIRE SAFE

DN	VALVE RATING	VALVE CODE	DESCRIPTION	VALVE PRICE (€)	KIT CODE	KIT PRICE (€)
06	PN63	A2406UAS2-0002-M0000	ALFA24K DN06 PN63 CF8M GAS		N.A. (*)	
06	PN63	A2406UAS2-0001-M0000	ALFA24K DN06 PN63 CF8M NPT		N.A. (*)	
06	PN63	A2406UAS2-0004-M0000	ALFA24K DN06 PN63 CF8M BW		N.A. (*)	
06	PN63	A2406UAS2-0003-M0000	ALFA24K DN06 PN63 CF8M SW		N.A. (*)	
10	PN63	A2410UAS2-0002-M0000	ALFA24K DN10 PN63 CF8M GAS		N.A. (*)	
10	PN63	A2410UAS2-0001-M0000	ALFA24K DN10 PN63 CF8M NPT		N.A. (*)	
10	PN63	A2410UAS2-0004-M0000	ALFA24K DN10 PN63 CF8M BW		N.A. (*)	
10	PN63	A2410UAS2-0003-M0000	ALFA24K DN10 PN63 CF8M SW		N.A. (*)	
<b>15</b>	<b>PN63</b>	<b>A2415UAS2-0004-M0000</b>	<b>ALFA24K DN15 PN63 CF8M GAS</b>		<b>KGA2415UA-001</b>	
<b>15</b>	<b>PN63</b>	<b>A2415UAS2-0001-M0000</b>	<b>ALFA24K DN15 PN63 CF8M NPT</b>		<b>KGA2415UA-001</b>	
15	PN63	A2415UAS2-0008-M0000	ALFA24K DN15 PN63 CF8M BW		KGA2415UA-001	
15	PN63	A2415UAS2-0006-M0000	ALFA24K DN15 PN63 CF8M SW		KGA2415UA-001	
<b>20</b>	<b>PN63</b>	<b>A2420UAS2-0004-M0000</b>	<b>ALFA24K DN20 PN63 CF8M GAS</b>		<b>KGA2420UA-001</b>	
<b>20</b>	<b>PN63</b>	<b>A2420UAS2-0003-M0000</b>	<b>ALFA24K DN20 PN63 CF8M NPT</b>		<b>KGA2420UA-001</b>	
20	PN63	A2420UAS2-0006-M0000	ALFA24K DN20 PN63 CF8M BW		KGA2420UA-001	
20	PN63	A2420UAS2-0005-M0000	ALFA24K DN20 PN63 CF8M SW		KGA2420UA-001	
<b>25</b>	<b>PN63</b>	<b>A2425UAS2-0004-M0000</b>	<b>ALFA24K DN25 PN63 CF8M GAS</b>		<b>KGA2425UA-001</b>	
<b>25</b>	<b>PN63</b>	<b>A2425UAS2-0002-M0000</b>	<b>ALFA24K DN25 PN63 CF8M NPT</b>		<b>KGA2425UA-001</b>	
25	PN63	A2425UAS2-0005-M0000	ALFA24K DN25 PN63 CF8M BW		KGA2425UA-001	
25	PN63	A2425UAS2-0003-M0000	ALFA24K DN25 PN63 CF8M SW		KGA2425UA-001	
32	PN63	A2432UAS2-0003-M0000	ALFA24K DN32 PN63 CF8M GAS		KGA2432UA-001	
32	PN63	A2432UAS2-0002-M0000	ALFA24K DN32 PN63 CF8M NPT		KGA2432UA-001	
32	PN63	A2432UAS2-0005-M0000	ALFA24K DN32 PN63 CF8M BW		KGA2432UA-001	
32	PN63	A2432UAS2-0004-M0000	ALFA24K DN32 PN63 CF8M SW		KGA2432UA-001	
<b>40</b>	<b>PN63</b>	<b>A2440UAS2-0006-M0000</b>	<b>ALFA24K DN40 PN63 CF8M GAS</b>		<b>KGA2440UA-001</b>	
<b>40</b>	<b>PN63</b>	<b>A2440UAS2-0005-M0000</b>	<b>ALFA24K DN40 PN63 CF8M NPT</b>		<b>KGA2440UA-001</b>	
40	PN63	A2440UAS2-0008-M0000	ALFA24K DN40 PN63 CF8M BW		KGA2440UA-001	
40	PN63	A2440UAS2-0007-M0000	ALFA24K DN40 PN63 CF8M SW		KGA2440UA-001	
<b>50</b>	<b>PN40</b>	<b>A2450U9S2-0002-M0000</b>	<b>ALFA24K DN50 PN40 CF8M GAS</b>		<b>KGA2450U9-001</b>	
<b>50</b>	<b>PN40</b>	<b>A2450U9S2-0001-M0000</b>	<b>ALFA24K DN50 PN40 CF8M NPT</b>		<b>KGA2450U9-001</b>	
50	PN40	A2450U9S2-0004-M0000	ALFA24K DN50 PN40 CF8M BW		KGA2450U9-001	
50	PN40	A2450U9S2-0003-M0000	ALFA24K DN50 PN40 CF8M SW		KGA2450U9-001	
80	PN40	A2480UA0962-0004-M0000	ALFA24K DN80 PN40 CF8M BW		KGA2480U9-001	

(\*) FOR VALVES DN06/DN10 SPARE PARTS KIT WILL NOT BE AVAILABLE - I KIT DI RICAMBIO NON SONO DISPONIBILI PER VALVOLE DN06/10

CF8M



Product codes in bold are related to product available on stock: delivery time within 3 weeks based on ordered quantity.

All other codes are related to product ready for assembly: delivery time within 5 weeks based on ordered quantity.

Missing Sizes and Special Executions are available upon request. Please contact Sales Dept. for availability and delivery time

I codici in grassetto indicano prodotti normalmente disponibili a stock: consegna entro 3 settimane secondo quantità ordinate

Gli altri codici indicano prodotti disponibili per assemblaggio: consegna entro 5 settimane secondo quantità ordinate

Dimensioni mancanti ed esecuzioni speciali sono disponibili su richiesta. Si prega contattare Ufficio commerciale per disponibilità e consegne