

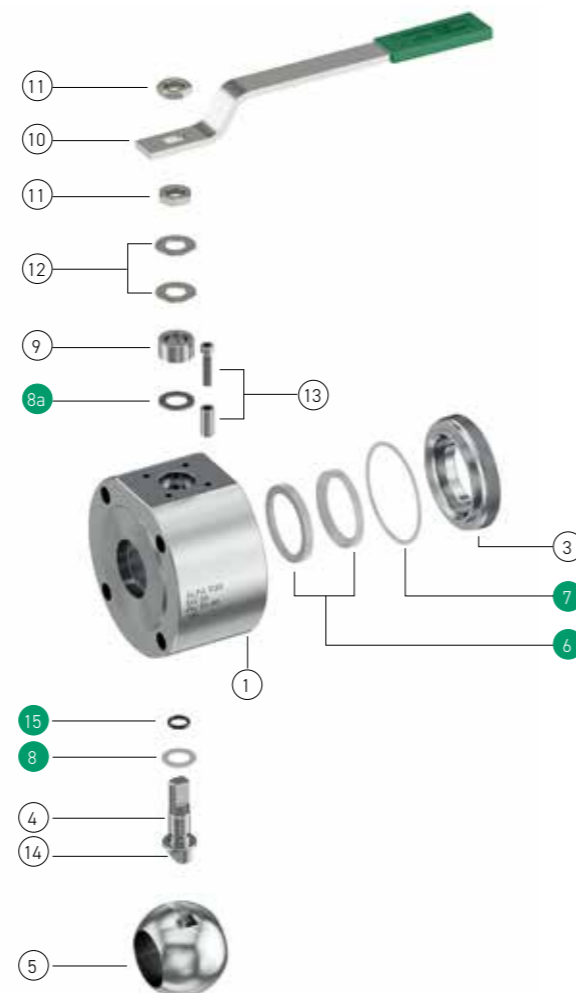

# A10N PN10-40 wafer type ball valve

BAR STOCK BODY  
CORPO DA BARRA

PART NAME PARTICOLARE	Q.TY Q.TA'	MATERIALS MATERIALI
1 body corpo	1	ASTM A105 ASTM A479 316/316L
3 closure chiusura	1	ASTM A105 ASTM A479 316/316L
4 stem stelo	1	ASTM A479 F6a (AISI 410) ASTM A182 316/316L
5 ball sfera	1	ASTM A351 CF8 ASTM A351 CF8M
6 seats sedi	2	TFM
7 body gasket guarnizione corpo	1	P.T.F.E.
8 washer bussola	1	P.T.F.E.
8a stem gasket guarnizione stelo	1	GRAPHOIL
9 gland preguarnizione	1	Carbon steel zinc coated Stainless Steel 316
10 lever leva	1	Carbon steel zinc coated
11 stem nut dado stelo	2	Cl.8 A4-40 (AISI 316)
12 spring washer molla a tazza	2	51 CrV4 Zinc coated AISI 316
13 stop device dispositivo di arresto	1	Cl. 8.8 Zinc Coated AISI 316
14 antistatic device dispositivo antistatico	2	AISI 316
15 stem o-ring o-ring stelo	1	VITON 75 Sh. A



Spares parts / Parti di ricambio

## STANDARD FEATURES CARATTERISTICHE STANDARD

Flange Facing, RF according / Finitura Flange, RF secondo : EN 1092-1
Flange drilling, metric holes according / Foratura flange, fori metrici secondo : EN1092-1, PN16
Face to face / Scartamento : EN 558-1
Design according to / Progettazione secondo : ASME B16.34, EN 12516-1, PED 2014/68/UE
Fire Safe Design and Construction according to / Costruzione e assemblaggio Fire Safe secondo : EN ISO 10497, API 6FA, API 607
Antistatic Device according to / Dispositivo antistatico secondo: BS 5146
Tightness class / Classe di tenuta : VI (FCI 70-2 - ANSI B 16.104)
Stem sealing with O-ring, Anti Blow-out stem / Tenuta stelo con O-Ring, Stelo anti-espulsione
Actuator coupling flange according to / Flangia integrata per montaggio comando secondo : ISO 5211

## A10N PN10-40 CARBON STEEL BODY / CORPO ACCIAIO AL CARBONIO

DN	VALVE RATING	VALVE CODE	DESCRIPTION	VALVE PRICE (€)	KIT CODE	KIT PRICE (€)
15	PN 10-40	A1N15U4C5-0001-M0010	ALFA10N DN15 PN10-40 A105 FS RF MET		KGA1N15A1-001	
20	PN 10-40	A1N20U4C5-0001-M0010	ALFA10N DN20 PN10-40 A105 FS RF MET		KGA1N20A1-001	
25	PN 10-40	A1N25U4C5-0001-M0010	ALFA10N DN25 PN10-40 A105 FS RF MET		KGA1N25A1-001	
32	PN 10-40	A1N32U4C5-0001-M0010	ALFA10N DN32 PN10-40 A105 FS RF MET		KGA1N32A1-001	
40	PN 10-40	A1N40U4C5-0001-M0010	ALFA10N DN40 PN10-40 A105 FS RF MET		KGA1N40A1-001	
50	PN 10-40	A1N50U4C5-0001-M0010	ALFA10N DN50 PN10-40 A105 FS RF MET		KGA1N50A1-001	
65	PN 10-16	A1N65U3C5-0001-M0010	ALFA10N DN65 PN10-16 A105 FS RF MET		KGA1N65A1-001	
80	PN 16-40	A1N80U6C5-0001-M0010	ALFA10N DN80 PN16-40 A105 FS RF MET		KGA1N80A1-001	
100	PN 10-16	A1NA0U3C5-0001-M0010	ALFA10N DN100 PN10-16 A105 FS RF MET		KGA1NA0A1-001	

## A10N PN10-40 STAINLESS STEEL BODY / CORPO ACCIAIO INOSSIDABILE

DN	VALVE RATING	VALVE CODE	DESCRIPTION	VALVE PRICE (€)	KIT CODE	KIT PRICE (€)
15	PN 10-40	A1N15U4SD-0001-M0000	ALFA10N DN15 PN10-40 316/316L FS RF MET		KGA1N15A1-001	
20	PN 10-40	A1N20U4SD-0001-M0000	ALFA10N DN20 PN10-40 316/316L FS RF MET		KGA1N20A1-001	
25	PN 10-40	A1N25U4SD-0001-M0000	ALFA10N DN25 PN10-40 316/316L FS RF MET		KGA1N25A1-001	
32	PN 10-40	A1N32U4SD-0001-M0000	ALFA10N DN32 PN10-40 316/316L FS RF MET		KGA1N32A1-001	
40	PN 10-40	A1N40U4SD-0001-M0000	ALFA10N DN40 PN10-40 316/316L FS RF MET		KGA1N40A1-001	
50	PN 10-40	A1N50U4SD-0001-M0000	ALFA10N DN50 PN10-40 316/316L FS RF MET		KGA1N50A1-001	
65	PN 10-16	A1N65U3SD-0001-M0000	ALFA10N DN65 PN10-16 316/316L FS RF MET		KGA1N65A1-001	
80	PN 16-40	A1N80U6SD-0001-M0000	ALFA10N DN80 PN16-40 316/316L FS RF MET		KGA1N80A1-001	
100	PN 10-16	A1NA0U3SD-0001-M0000	ALFA10N DN100 PN10-16 316/316L FS RF MET		KGA1NA0A1-001	



Product codes in bold are related to product available on stock; delivery time within 3 weeks based on ordered quantity.

All other codes are related to product ready for assembly; delivery time within 5 weeks based on ordered quantity.

Missing Sizes and Special Executions are available upon request. Please contact Sales Dept. for availability and delivery time

I codici in grassetto indicano prodotti normalmente disponibili a stock; consegna entro 3 settimane secondo quantità ordinate

Gli altri codici indicano prodotti disponibili per assemblaggio; consegna entro 5 settimane secondo quantità ordinate

Dimensioni mancanti ed esecuzioni speciali sono disponibili su richiesta. Si prega contattare Ufficio commerciale per disponibilità e consegne