

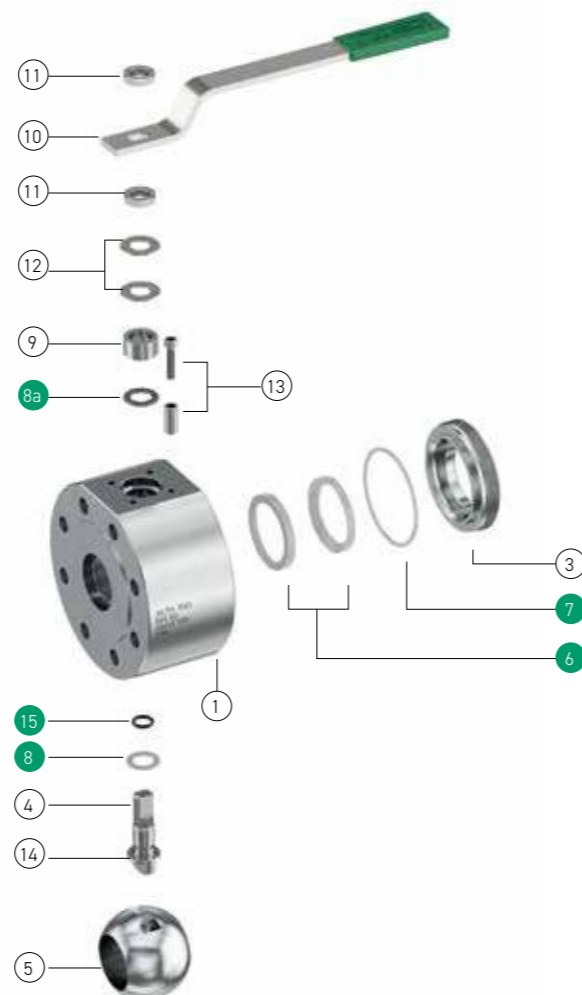

A10N ANSI 300 wafer type ball valve

PART NAME PARTICOLARE	Q.TY Q.TA'	MATERIALS MATERIALI	
1 body corpo	1	ASTM A105 *	ASTM A479 316/316L **
3 closure chiusura	1	ASTM A105 *	ASTM A479 316/316L **
4 stem stelo	1	ASTM A479 F6a (AISI 410)	ASTM A182 316/316L
5 ball sfera	1	ASTM A351 CF8	ASTM A351 CF8M
6 seats sedi	2	TFM	
7 body gasket guarnizione corpo	1	P.T.F.E./GRAPHOIL (DN > 100)	
8 washer bussola	1	P.T.F.E.	
8a stem gasket guarnizione stelo	1	GRAPHOIL	
9 gland premi-guarnizione	1	Carbon steel Zinc Coated	Stainless Steel 316
10 lever leva	1	Carbon steel Zinc Coated	
11 stem nut dado stelo	2	Cl.8	A4-40 (AISI 316)
12 spring washer molla a tazza	2	51CrV4 Zinc Coated	AISI 316
13 stop device dispositivo di arresto	1	Cl. 8.8 Zinc Coated	AISI 316
14 antistatic device dispositivo antistatico	2	AISI 316	
15 stem o-ring o-ring stelo	1	VITON 75 Sh. A	
16 body o-ring (DN > 100) o-ring corpo	1	P.T.F.E.	



- * DN > 125: ASTM A216 WCB
- ** DN > 125: ASTM A351 CF8M
- 🔄 Spares parts / Parti di ricambio

STANDARD FEATURES CARATTERISTICHE STANDARD

- Flange Facing RF according / Finitura Flange secondo : ASME B16.5, ANSI 300
- Flange drilling, metric holes according / Foratura flange, fori metrici secondo : ASME B16.5, ANSI 300
- Face to face / Scartamento : EN 558-1
- Design according to / Progettazione secondo : ASME B16.34, EN 12516-1, PED 2014/68/UE
- Fire Safe Design and Construction according to / Costruzione e assemblaggio Fire Safe secondo : EN ISO 10497, API 6FA, API 607
- Antistatic Device according to / Dispositivo antistatico secondo : BS 5146
- Tightness class / Classe di tenuta : VI (FCI 70-2 - ANSI B 16.104)
- Stem sealing with O-ring, Anti Blow-out stem / Tenuta stelo con O-Ring, stelo anti-espulsione
- Actuator coupling flange according to / Flangia integrata per montaggio comando secondo : ISO 5211

A10N ANSI 300 CARBON STEEL BODY / CORPO ACCIAIO AL CARBONIO

A105
WCB*

DN	VALVE RATING	VALVE CODE	DESCRIPTION	VALVE PRICE (€)	KIT CODE	KIT PRICE (€)
15	ANSI 300	A1N15A2C5-0002-M0010	ALFA10N DN15 ANSI300 A105 FS RF MET		KGA1N15A1-001	
20	ANSI 300	A1N20A2C5-0002-M0010	ALFA10N DN20 ANSI300 A105 FS RF MET		KGA1N20A1-001	
25	ANSI 300	A1N25A2C5-0002-M0010	ALFA10N DN25 ANSI300 A105 FS RF MET		KGA1N25A1-001	
32	ANSI 300	A1N32A2C5-0002-M0010	ALFA10N DN32 ANSI300 A105 FS RF MET		KGA1N32A1-001	
40	ANSI 300	A1N40A2C5-0002-M0010	ALFA10N DN40 ANSI300 A105 FS RF MET		KGA1N40A1-001	
50	ANSI 300	A1N50A2C5-0001-M0010	ALFA10N DN50 ANSI300 A105 FS RF MET		KGA1N50A1-001	
65	ANSI 300	A1N65A2C5-0001-M0010	ALFA10N DN65 ANSI300 A105 FS RF MET		KGA1N65A1-001	
80	ANSI 300	A1N80A2C5-0001-M0010	ALFA10N DN80 ANSI300 A105 FS RF MET		KGA1N80A1-001	
100	ANSI 300	A1NA0A2C5-0001-M0010	ALFA10N DN100 ANSI300 A105 FS RF MET		KGA1N40A1-001	
*125	ANSI 300	A1NA2A2C1-0001-M0010	ALFA10NF DN125 ANSI300 WCB FS RF MET		KGA64A2A1-002	
*150	ANSI 300	A1NA5A2C1-0001-M0010	ALFA10NF DN150 ANSI300 WCB FS RF MET		KGA64A5A1-002	

A10N ANSI 300 STAINLESS STEEL BODY / CORPO ACCIAIO INOSSIDABILE

316(L)
CF8M**

DN	VALVE RATING	VALVE CODE	DESCRIPTION	VALVE PRICE (€)	KIT CODE	KIT PRICE (€)
15	ANSI 300	A1N15A2SD-0001-M0000	ALFA10N DN15 ANSI300 316/316L FS RF MET		KGA1N15A1-001	
20	ANSI 300	A1N20A2SD-0001-M0000	ALFA10N DN20 ANSI300 316/316L FS RF MET		KGA1N20A1-001	
25	ANSI 300	A1N25A2SD-0001-M0000	ALFA10N DN25 ANSI300 316/316L FS RF MET		KGA1N25A1-001	
32	ANSI 300	A1N32A2SD-0001-M0000	ALFA10N DN32 ANSI300 316/316L FS RF MET		KGA1N32A1-001	
40	ANSI 300	A1N40A2SD-0001-M0000	ALFA10N DN40 ANSI300 316/316L FS RF MET		KGA1N40A1-001	
50	ANSI 300	A1N50A2SD-0001-M0000	ALFA10N DN50 ANSI300 316/316L FS RF MET		KGA1N50A1-001	
65	ANSI 300	A1N65A2SD-0001-M0000	ALFA10N DN65 ANSI300 316/316L FS RF MET		KGA1N65A1-001	
80	ANSI 300	A1N80A2SD-0001-M0000	ALFA10N DN80 ANSI300 316/316L FS RF MET		KGA1N80A1-001	
100	ANSI 300	A1NA0A2SD-0001-M0000	ALFA10N DN100 ANSI300 316/316L FS RF MET		KGA1NA0A1-001	
**125	ANSI 300	A1NA2A2S2-0001-M0000	ALFA10NF DN125 ANSI300 CF8M FS RF MET		KGA64A2A1-002	
**150	ANSI 300	A1NA5A2S2-0001-M0000	ALFA10NF DN150 ANSI300 CF8M FS RF MET		KGA64A5A1-002	



Product codes in bold are related to product available on stock; delivery time within 3 weeks based on ordered quantity.
 All other codes are related to product ready for assembly; delivery time within 5 weeks based on ordered quantity.
 Missing Sizes and Special Executions are available upon request. Please contact Sales Dept. for availability and delivery time.
I codici in grassetto indicano prodotti normalmente disponibili a stock; consegna entro 3 settimane secondo quantità ordinate.
 Gli altri codici indicano prodotti disponibili per assemblaggio; consegna entro 5 settimane secondo quantità ordinate.
 Dimensioni mancanti ed esecuzioni speciali sono disponibili su richiesta. Si prega di contattare Ufficio commerciale per disponibilità e consegne.