



A103 PN10-40 ANSI 150

3 way wafer type ball valve

INVESTMENT CASTING BODY
CORPO DA FUSIONE

| PART NAME PARTICOLARE | Q.TY Q.TA' | MATERIALS MATERIALI | |
|--|---------------|--------------------------|---------------------|
| 1 body corpo | 1 | ASTM A216 WCB | ASTM A351 CF8M |
| 3 closure chiusura | 1 | ASTM A216 WCB | ASTM A351 CF8M |
| 4 stem stelo | 1 | ASTM A479 F6a (AISI 410) | ASTM A182 316/316L |
| 5 ball sfera | 1 | ASTM A351 CF8M | |
| 6 seats sedi | 2 | TFM | |
| 7 body gasket guarnizione corpo | 1 | P.T.F.E. | |
| 8 washer bussola | 1 | P.T.F.E. | |
| 8a stem gasket guarnizione stelo | 1 | P.T.F.E. | |
| 9 gland premi-guarnizione | 1 | Carbon Steel Zinc Coated | Stainless Steel 316 |
| 10 lever leva | 1 | Carbon Steel Zinc Coated | |
| 11 stem nut dado stelo | 2 | Cl. 8 | A4-40 (AISI 316) |
| 12 spring washer molla a tazza | 2 | 51CrV4 Zinc Coated | AISI 316 |
| 13 stop device dispositivo di arresto | 1 | Cl. 8.8 Zinc Coated | AISI 316 |
| 14 antistatic device dispositivo antistatico | 2 | AISI 316 | |
| 15 stem o-ring o-ring stelo | 1 | VITON 75 Sh. A | |
| 16 body o-ring/o-ring corpo DN150 only | 1 | VITON 75 Sh. A | |
| 17 position indicator indicatore di posizione | 1 | AISI 316 | |

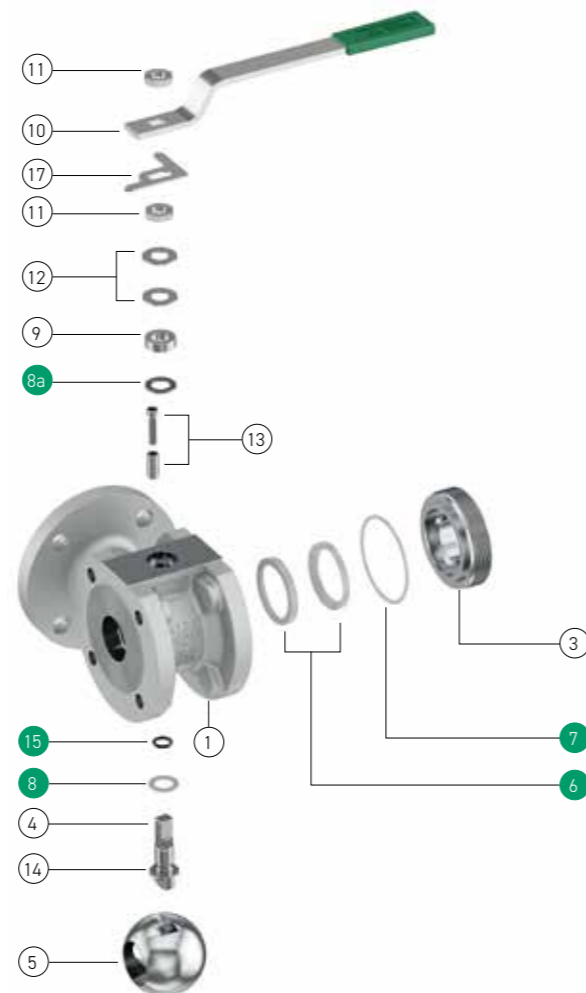

Spares parts / Parti di ricambio

STANDARD FEATURES CARATTERISTICHE STANDARD

| |
|---|
| Flange Facing RF according to / Finitura Flange RF secondo : ASME B.16.5, ANSI 150 or EN 1092-1 |
| Flange drilling, metric holes according / Foratura flange, fori metrici secondo : ASME B16.5 (ANSI 150) or EN 1092-1 (PN16) |
| Face to face / Scartamento : Manufacturer standard |
| Design according to/ Progettazione secondo : ASME B16.34, EN 12516-1, PED 2014/68/UE |
| Antistatic Device according to /Dispositivo antistatico secondo : BS 5146 |
| Tightness class / Classe di tenuta VI (FCI 70-2 - ANSI B 16.104) |
| Stem sealing with O-ring, Anti Blow-out stem / Tenuta stelo con O-Ring, stelo anti-espulsione |
| Actuator coupling flange according to / Flangia integrata per montaggio comando secondo : ISO 5211 |

A103 PN10-40 CARBON STEEL BODY / CORPO ACCIAIO AL CARBONIO

| DN | VALVE RATING | VALVE CODE | DESCRIPTION | VALVE PRICE (€) | KIT CODE | KIT PRICE (€) |
|-----|--------------|----------------------|-----------------------------------|-----------------|---------------|---------------|
| 20 | PN 10-40 | AC320U4C1-0001-M0010 | ALFA103 DN20 PN 10-40 WCB RF MET | | KGAC320A1-001 | |
| 25 | PN 10-40 | AC325U4C1-0002-M0010 | ALFA103 DN25 PN 10-40 WCB RF MET | | KGAC325A1-001 | |
| 32 | PN 10-40 | AC332U4C1-0001-M0010 | ALFA103 DN32 PN 10-40 WCB RF MET | | KGAC332A1-001 | |
| 40 | PN 10-40 | AC340U4C1-0002-M0010 | ALFA103 DN40 PN 10-40 WCB RF MET | | KGAC340A1-001 | |
| 50 | PN 10-40 | AC350U4C1-0001-M0010 | ALFA103 DN50 PN 10-40 WCB RF MET | | KGAC350A1-001 | |
| 65 | PN 10-16 | AC365U3C1-0001-M0010 | ALFA103 DN65 PN 10-16 WCB RF MET | | KGAC365A1-001 | |
| 80 | PN 16-40 | AC380U6C1-0002-M0010 | ALFA103 DN80 PN 16-40 WCB RF MET | | KGAC380A1-001 | |
| 100 | PN 10-16 | AC3A0U3C1-0001-M0010 | ALFA103 DN100 PN 10-16 WCB RF MET | | KGAC3A0A1-001 | |
| 150 | PN 10-16 | AC3A5U3C1-0001-M0010 | ALFA103 DN150 PN 10-16 WCB RF MET | | KGAC3A5A1-001 | |

A103 PN10-40 STAINLESS STEEL BODY / CORPO ACCIAIO INOSSIDABILE

| DN | VALVE RATING | VALVE CODE | DESCRIPTION | VALVE PRICE (€) | KIT CODE | KIT PRICE (€) |
|-----|--------------|----------------------|--------------------------------|-----------------|---------------|---------------|
| 20 | PN 10-40 | AC320U4S2-0001-M0000 | ALFA103 DN20 PN 10-40 CF8M RF | | KGAC320A1-001 | |
| 25 | PN 10-40 | AC325U4S2-0001-M0000 | ALFA103 DN25 PN 10-40 CF8M RF | | KGAC325A1-001 | |
| 32 | PN 10-40 | AC332U4S2-0001-M0000 | ALFA103 DN32 PN 10-40 CF8M RF | | KGAC332A1-001 | |
| 40 | PN 10-40 | AC340U4S2-0001-M0000 | ALFA103 DN40 PN 10-40 CF8M RF | | KGAC340A1-001 | |
| 50 | PN 10-40 | AC350U4S2-0001-M0000 | ALFA103 DN50 PN 10-40 CF8M RF | | KGAC350A1-001 | |
| 65 | PN 10-16 | AC365U3S2-0001-M0000 | ALFA103 DN65 PN 10-16 CF8M RF | | KGAC365A1-001 | |
| 80 | PN 16-40 | AC380U6S2-0001-M0000 | ALFA103 DN80 PN 16-40 CF8M RF | | KGAC380A1-001 | |
| 100 | PN 10-16 | AC365U3S2-0001-M0000 | ALFA103 DN100 PN 10-16 CF8M RF | | KGAC3A0A1-001 | |
| 150 | PN 10-16 | AC3A5U3S2-0001-M0000 | ALFA103 DN150 PN 10-16 CF8M RF | | KGAC3A5A1-001 | |



Product codes in bold are related to product available on stock; delivery time within 3 weeks based on ordered quantity.

All other codes are related to product ready for assembly; delivery time within 5 weeks based on ordered quantity. Missing Sizes and Special Executions are available upon request. Please contact Sales Dept. for availability and delivery time. I codici in grassetto indicano prodotti normalmente disponibili a stock; consegna entro 3 settimane secondo quantità ordinate.

Gli altri codici indicano prodotti disponibili per assemblaggio; consegna entro 5 settimane secondo quantità ordinate. Dimensioni mancanti ed esecuzioni speciali sono disponibili su richiesta. Si prega contattare Ufficio commerciale per disponibilità e consegne.